

NATIVE POLLINATORS

NATIVE BEES AND OTHER INSECTS DO MOST OF THE WORK SHARING POLLEN AMONG FLOWERS TO MAKE FRUIT. THE WOODEN STRUCTURES DRILLED WITH TINY HOLES ARE HOMES FOR THESE HELPFUL BUGS.

SOME CRITTERS YOU MIGHT SEE IN THE ORCHARD:

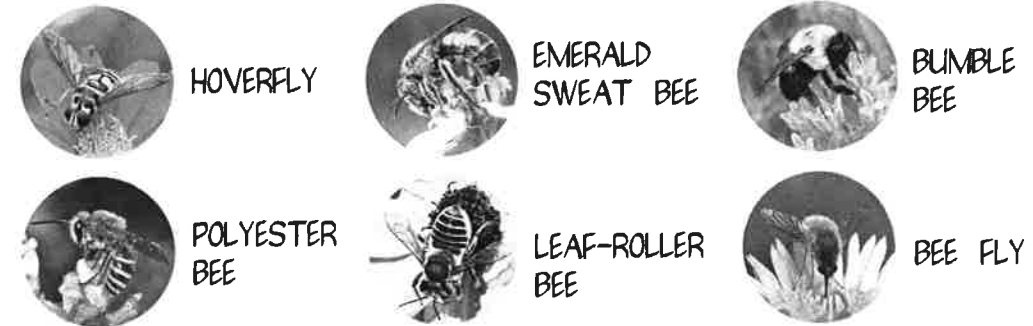

FRUIT KEY

- BLACKBERRY
 - 1 PRIME ARK
 - 2 ARAPAHO
 - 3 OSAGE
 - 4 TRIPLE CROWN
- BLUEBERRY
 - 1 COLUMBUS
 - 2 OCHLOCKONEE
 - 3 O'NEAL
 - 4 CLIMAX
 - 5 LEGACY
 - 6 VERNON
- BUSH CHERRY
 - 1 CARMINE JEWEL
 - 2 CRIMSON PASSION
- HONEYBERRY
 - 1 BLUE MOON
 - 2 BERRY BLUE
- GOOSEBERRY
 - 1 BLACK VELVET
 - 2 JAHN'S PRAIRIE
- RASPBERRY
 - 1 HERITAGE
 - 2 DOUBLE GOLD
 - 3 CAROLINE

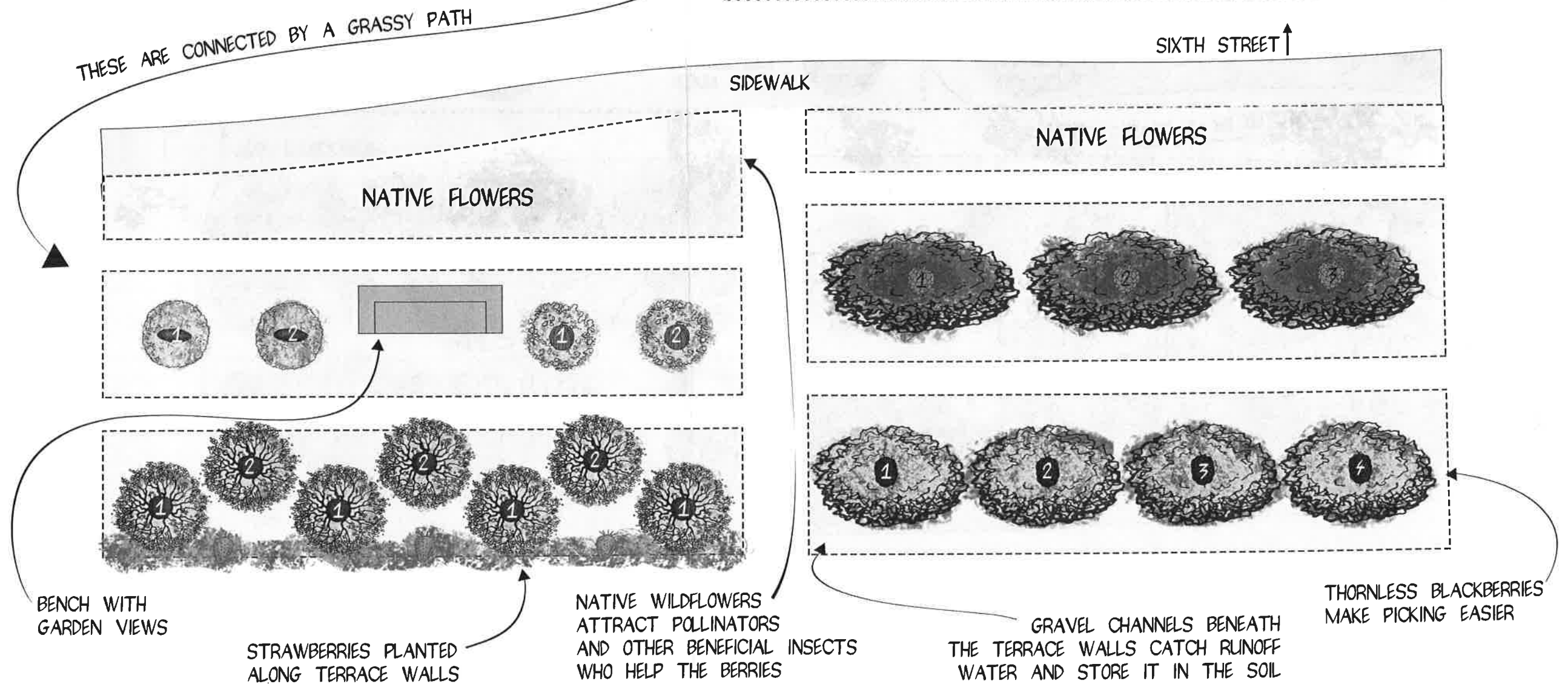

BERRY TERRACES

FRUIT TREES

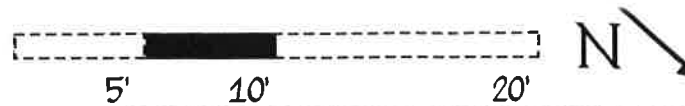

MONTICELLO AVE. ↑

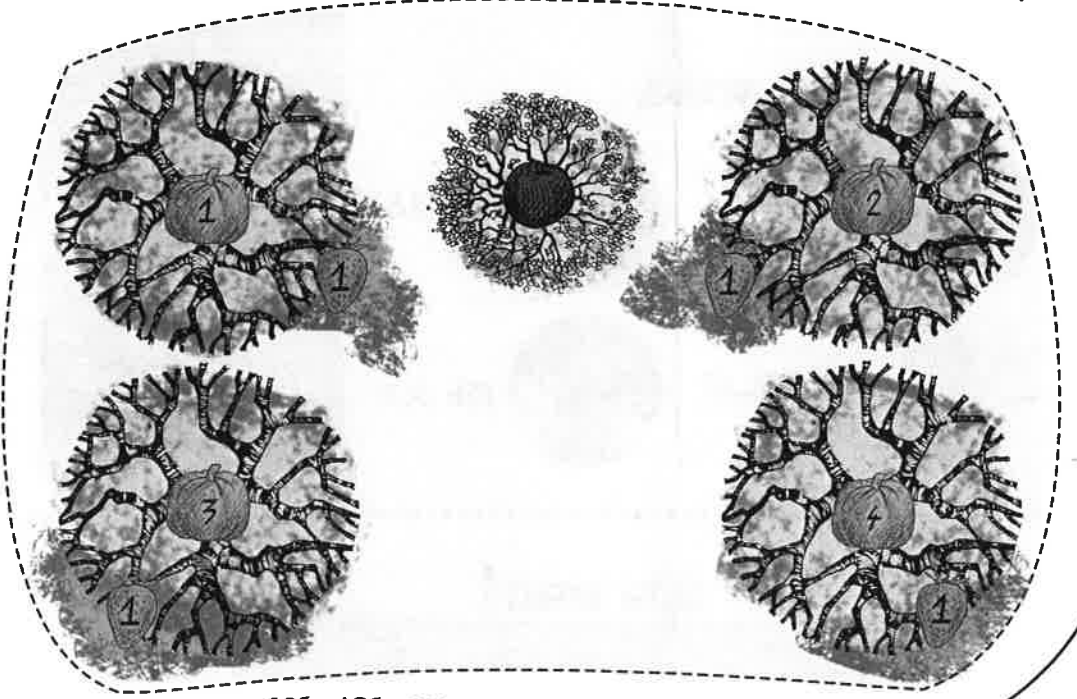

THESE ARE CONNECTED BY A GRASSY PATH

COMPANION PLANTS

YOU MIGHT NOTICE THAT THERE ARE MANY SMALL PLANTS AROUND THE FRUIT TREES AND BUSHES. THESE ARE NOT WEEDS! THEY ARE HELPFUL PLANTS THAT BRING IN BENEFICIAL INSECTS, PROVIDE FOOD AND MEDICINE, AND KEEP THE TREES HEALTHY.

SOME OF OUR FAVORITE COMPANIONS:



BEE BALM
- COOKING HERB
- POLLINATOR ATTRACTOR



LEMON BALM
- TEA HERB
- MOSQUITO REPELLANT



CHIVES
- COOKING HERB
- PEST DETERRENT



MOUNTAIN MINT
- TEA HERB
- POLLINATOR ATTRACTOR



COMFREY
- SOIL IMPROVER
- LIVING MULCH



NEW JERSEY TEA
- NITROGEN FIXER
- POLLINATOR ATTRACTOR

MONTICELLO AVE. ↑

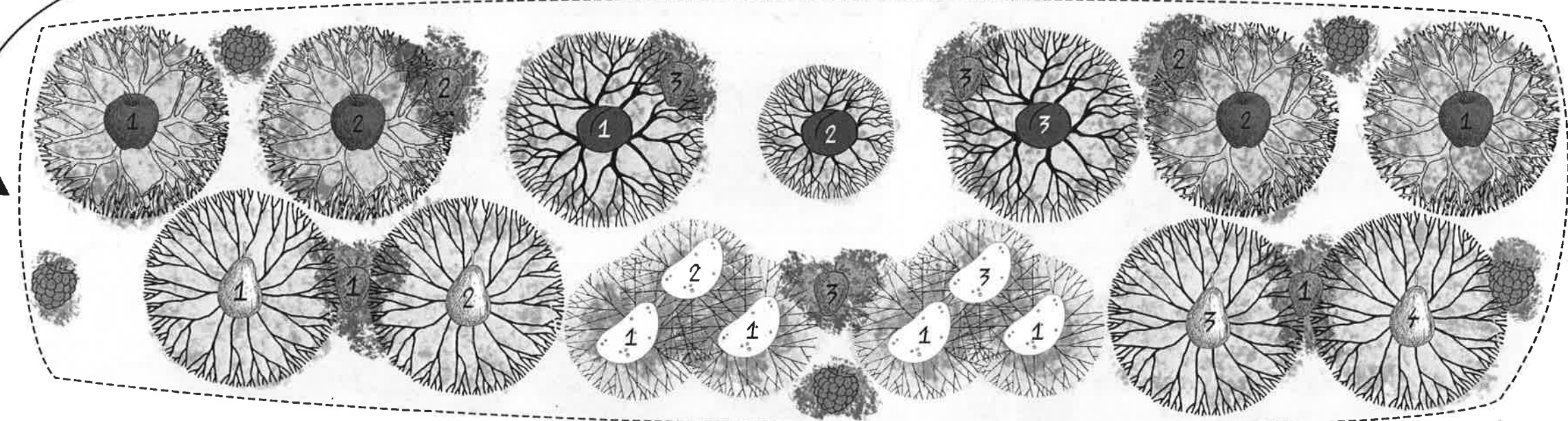

FRUIT KEY



PEARS
1 MAGNESS
2 KOREAN GIANT
3 SHINKO
4 BLAKE'S PRIDE



PAWPAWS
1 SELECT
2 SUNFLOWER
3 WILD



PLUMS
1 ALL RED
2 BEACH PLUM
3 METHLEY



PERSIMMONS
1 MATSUMOTO
2 HANA FUYU
3 JIRO
4 GWANG YANG



RASPBERRIES
JEWEL BLACK



STRAWBERRIES
1 SEASCAPE
2 SWEET CHARLIE
3 SPARKLE



APPLES
1 LIBERTY
2 WILLIAM'S PRIDE



JUNEBERRY
REGENT



FRIENDSHIP COURT COMMUNITY ORCHARD

WELCOME! THE ORCHARD IS OPEN TO ALL. BELOW ARE A FEW GUIDELINES:

- YOU MAY PICK AND EAT FRUIT GROWING IN THE HILLSIDE ORCHARD, JUST LEAVE SOME FOR OTHERS TO ENJOY.
- PLEASE DO NOT PICK VEGETABLES FROM THE GARDENS BELOW THE ORCHARD.
- RESPECT LOCAL RESIDENTS BY VISITING THE ORCHARD DURING DAYLIGHT HOURS.

FOR MORE INFORMATION OR TO SCHEDULE A TOUR, PLEASE CONTACT UACC:

434-989-0150
INFORMATION.UACC@GMAIL.COM
WWW.UACC.WORDPRESS.COM

THANK YOU TO THE MANY DONORS, VOLUNTEERS, AND COMMUNITY PARTNERS WHO MADE THIS PROJECT POSSIBLE!

